

# AZUR

## Undercounter Refrigerators, Wine Reserves and Beverage Centers



**Effective January 1, 2019**  
(Revised May 1, 2019)

**Azure Retail Price Book**

P.O. Box 1836

Dundee, FL 33838

Phone: 800-292-8374 • Fax: 800-574-8805

[www.pinnacleexpress.com](http://www.pinnacleexpress.com)



## UNDERCOUNTER REFRIGERATORS



### FEATURES

- Field reversible door
- ADA Compliant
- Digital display control
- Blue LED interior lighting
- 4 glass shelves
- Stainless handle on stainless door
- Pre-drilled mounting holes for overlay door
- Auto-defrost

### SPECIFICATIONS

- 15" Capacity = 3 CuFt.
  - 80 - 12oz cans
- 24" Capacity = 5.1 CuFt.
  - 154 - 12oz cans
- Temperature range: 34-43° F
- Adjustable height from 32" - 34.5"
- Certifications: ETL, ETL-C, CEC, DOE

## WINE RESERVES



### FEATURES

- Field reversible door
- ADA compliant
- Digital display control
- Blue LED interior lighting
- 6 wine racks with wood front
- Stainless handle on stainless trim
- Pre-drilled mounting holes for overlay trim
- Auto-defrost

### SPECIFICATIONS

- 15" Capacity = 3 CuFt.
  - 30 wine bottles
- 24" Capacity = 5.1 CuFt.
  - 48 wine bottles
- Temperature range: 40-60° F
- Adjustable height from 32" - 34.5"
- Certifications: ETL, ETL-C, CEC

## BEVERAGE CENTERS



### FEATURES

- Field reversible door
- ADA Compliant
- Digital display control
- Blue LED interior lighting
- 4 glass shelves
- 2 wine racks with wood front
- Stainless handle on stainless trim
- Pre-drilled mounting holes for overlay
- Auto-defrost

### SPECIFICATIONS

- 15" Capacity = 3 CuFt.
  - 10 wine bottles & 80 12oz cans\*
- 24" Capacity = 5.1 CuFt.
  - 16 wine bottles & 154 12oz cans\*
- Temperature range: 34-43° F
- Adjustable height from 32" - 34.5"
- Certifications: ETL, ETL-C, CEC

## DUAL ZONE BEVERAGE CENTER / WINE RESERVE NEW



### FEATURES

- French door swing
- ADA compliant
- Digital display control
- Blue LED interior lighting
- Stainless Handle
- Auto-defrost
- 3 Glass shelves in beverage center
- 5 Wood wine racks in wine reserve

### SPECIFICATIONS

- Beverage Center
  - 2.5 CuFt.
  - Holds up to 58 12oz. cans
  - Temperature Range 36 - 43°F
- Wine Reserve
  - 2.5 CuFt.
  - Holds up to 20 wine bottles
  - Temperature Range 40 - 65°F
- Certifications: ETL, ETL-C, CEC

\* Capacity listed for can storage is only accurate when wine racks are removed and glass shelves are being used.

**UNDERCOUNTER REFRIGERATORS**



A115R-S



A115R-O



A124R-S



A124R-O

Model	Description	MAP	MSRP (Retail)
A115R-S	15" Refrigerator with Solid Stainless Door	\$ 749	\$ 799
A115R-O	15" Refrigerator with Solid Overlay Door	\$ 749	\$ 799
A124R-S	24" Refrigerator with Solid Stainless Door	\$ 999	\$ 1,099
A124R-O	24" Refrigerator with Solid Overlay Door	\$ 999	\$ 1,099

**WINE RESERVES**



A115WC-S



A115WC-O



A124WC-S



A124WC-O

Model	Description	MAP	MSRP (Retail)
A115WC-S	15" Wine Center with Stainless Trim Glass Door	\$ 749	\$ 799
A115WC-O	15" Wine Center with Overlay Trim Glass Door	\$ 749	\$ 799
A124WC-S	24" Wine Center with Stainless Trim Glass Door	\$ 999	\$ 1,099
A124WC-O	24" Wine Center with Overlay Trim Glass Door	\$ 999	\$ 1,099

**BEVERAGE CENTERS**



A115BEV-S



A115BEV-O



A124BEV-S



A124BEV-O

Model	Description	MAP	MSRP (Retail)
A115BEV-S	15" Beverage Center with Stainless Trim Glass Door	\$ 749	\$ 799
A115BEV-O	15" Beverage Center with Overlay Trim Glass Door	\$ 749	\$ 799
A124BEV-S	24" Beverage Center with Stainless Trim Glass Door	\$ 999	\$ 1,099
A124BEV-O	24" Beverage Center with Overlay Trim Glass Door	\$ 999	\$ 1,099

**DUAL ZONE BEVERAGE CENTER / WINE RESERVE**



A124DZ-S



A124DZ-S

Model	Description	MAP	MSRP (Retail)
A124DZ-S	24" Dual Zone Beverage Center / Wine Reserve with Stainless Trim Glass Door	\$ 1,199	\$ 1,299

# Product Dimensions

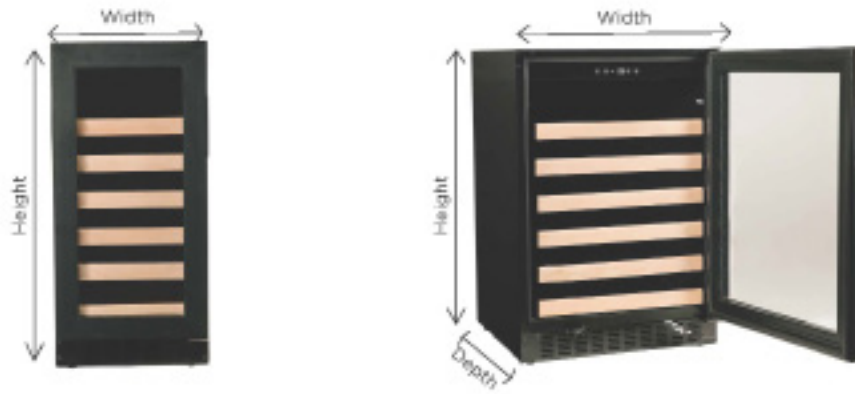

Model Size	Height	Width	Depth	Depth w/ Handle
15"	32" - 34 1/2"	14 5/8"	22 1/2"	24"
24"	32" - 34 1/2"	23 1/2"	22 1/2"	24"

## Cutout Dimensions for Cabinet

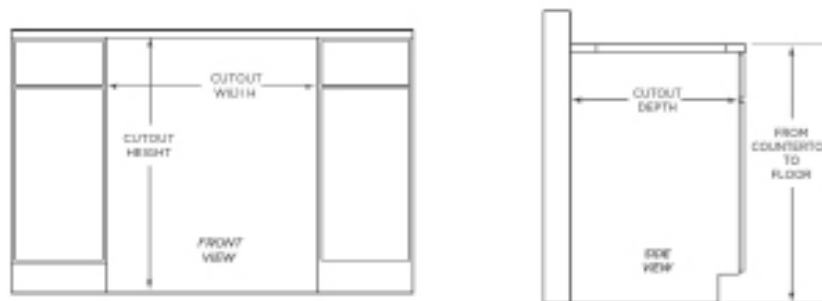

Model Size	Height	Width	Depth
15"	32 1/8" - 34 5/8"	14 3/4"	22 5/8"
24"	32 1/8" - 34 5/8"	23 5/8"	22 5/8"

## Electrical Requirements

- This refrigerator must be installed in accordance with National Electric Codes, as well as state, municipal and local codes
- The correct voltage, frequency and amperage must be supplied to the refrigerator from a grounded circuit which is protected by a properly sized circuit breaker or time delay fuse.
- The proper voltage, frequency and amperage ratings are listed on the product rating plate.
- The refrigerator must be properly grounded at all times when electrical power is applied.
- Use the legs of the unit to properly level it in your cabinet.
- Never allow any debris to build up underneath, or in front of the unit, blocking ventilation.

**Important Note to Installer:** This file is not intended to replace your Owners' Manual which contains specific safety requirements and consumer guidelines. Please refer to your Owners' Manual prior to installing or operating your appliance.



P.O. Box 1836  
 Dundee, FL 33838  
 Phone: 800-292-8374 • Fax: 800-574-8805  
[www.pinnacleexpress.com](http://www.pinnacleexpress.com)